



headquarters in Boettingen, Germany

### Specialized in high-tech for many years

A process and solution-oriented automation system supplier – providing all aspects from one source: SHL plans, designs, and manufactures robot facilities and systems for grinding, polishing, deburring, brushing, and milling processes, as well as for various handling tasks.

With qualified experts from different fields of competence, the technology company, based in Böttingen, has built 1,500 systems worldwide for companies from various industries, such as plumbing fixtures, automotive parts, door fittings, medical engineering, or household appliances. This makes SHL one of the largest automation system suppliers in the fields of grinding, polishing and deburring.

## ADDITIONAL ELEMENTS FOR GRINDING FOR THE MACHINE TYPES DKS.../FKS...

### Higher flexibility plus added performance: The additional SHL elements – for your FKS and DKS grinder.

You want to use your SHL free belt or double free belt contact roll grinder (FKS/DKS) even more productively and efficiently?

We offer the perfectly matching additional elements and extensions for different requirements and areas of application in your production.

Good to know: Our additional elements were constructed under consideration of the special requirements for grinding and deburring of profiled work pieces and moulded parts – even in case of complex contours or materials made of metal, NF-metals, wood and plastics at different belt speeds.

### Our components, your advantages.

More processing freedom!  
Higher safety for your processes!  
Lower downtimes and equipment times!



**SHL Automatisationstechnik AG**  
Spaichinger Weg 14, D-78583 Böttingen

Fon: +49-(0)7429 - 9304-0  
Fax: +49-(0)7429 - 9304-50  
Internet: [www.shl.ag](http://www.shl.ag)  
E-Mail: [info@shl.ag](mailto:info@shl.ag)

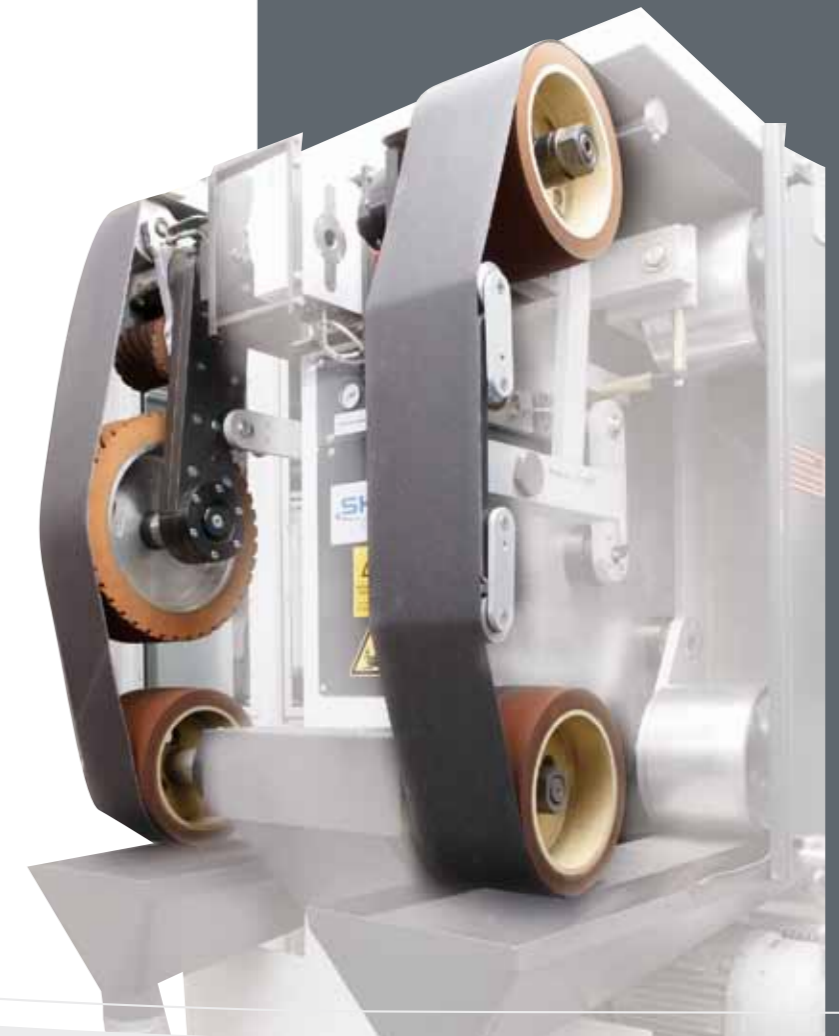

## SHL ADDITIONAL ELEMENTS – EXPANSIONS

### Belt blow-off device

Unlimited, consistent quality: With this component, the belt can be cleaned during current operation. In addition to even material removal, you are protecting yourself from premature belt wear.

- For non-lubricating materials only



### Simple preliminary spindle – VS 60-120-150-x

With the integrated press-on regulation, production-related raw part tolerances can be balanced out.

- Roll diameter max. 120 mm, min. 60 mm (depending on speed)
- Roll width max. 150 mm

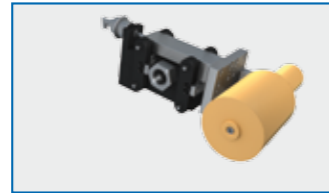

### Triple preliminary spindle – VS 60-120-100-x

Different materials removal for many different processing radiuses:

The roll used is replaced automatically. You have a choice between three different rolls. The rolls can also be replaced during the process via the control (programming).

- Roll diameter max. 120 mm, min. 60 mm (depending on speed)
- Roll width max. 100 mm

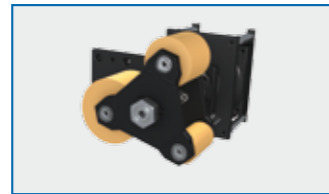

### Extended work spindle

Perfection for surface finish: the extended drive spindle enables application of additional grinding media.

- Spindle diameter 35 mm
- Disc diameter max. 350 mm (depending on speed)

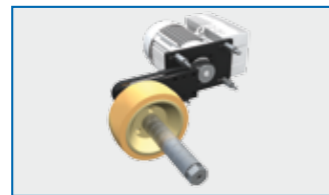

### Exhaust flap – ALK 140

Improve process safety and optimise suction power.

The machine parts not used are isolated from the system suction device according to the machine functions used.

- Diameter 140 mm

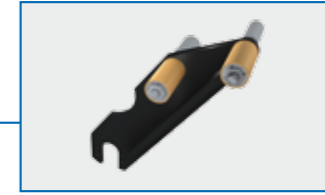
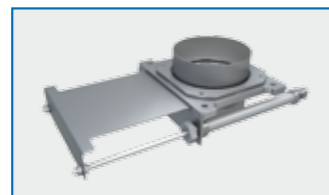

### Small contact roll – AK 60-50-50-x

This expansion makes it possible to grind and polish in very narrow radiuses.

- Roll diameter max. 60 mm (depending on speed)
- Roll width max. 50 mm



### Grinding emulsion for aluminium processing

To reduce risk for even materials removal and best quality, the grinding belt has to be continually flushed free when processing aluminium or forging materials.

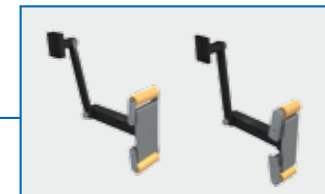

### Grinding shoe – SS 250-150

An indispensable expansion, also for sharp-edged work pieces: Process level areas with sharp edges – combined with flat areas. Easy, no stretching, no additional processing step.

- Width max. 150 mm
- Length 250 mm

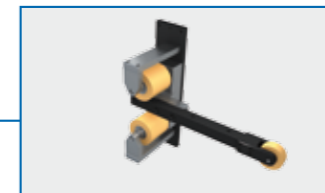

### Special grinding top

This special grinding top can be adjusted to the application or process.

- Roll diameter 50-80 mm
- Belt width 30-60 mm

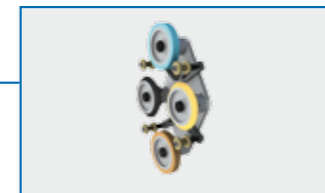

### Quadruple special grinding attachment

Different material removal with different processing radiuses:

The roll used is replaced automatically.

You have a choice between four different contact rolls.

The rolls can also be replaced during the process via the control (programming).

Thus, you have an even higher flexibility in your process.

- Contact disc diameter 150 mm
- Belt width max. 25 mm

Attention special construction of the SHL DKS/FKS required!